

Water Treatment



TMP1 Series

MECHANICAL DIAPHRAGM PUMP



Main technical characteristics

- Flow Rate up to 530 L/h
- Pressure up to 12 bar
- Mechanically actuated PTFE diaphragm
- Flow rate adjustment from 0 to 100%
- Stroke Rate: 58 / 78 / 116 / 156 strokes/minute
- Stroke Length: 2 / 4 / 6,4 / 7,4 mm
- Diaphragm Diameter: 65 / 96 / 124 / 140 mm
- Motor: 0,25 / 0,37 kW
- Maximum temperature of pumped liquid: 40 °C
- Maximum ambient temperature: 55 °C
- Stroke adjustment with locking system
- Enclosure Protection Class: IP55
- Material of Pump Head:- SS 316L or - PVDF

Water Treatment



General features

- TMP1 dosing pumps offer a high level of reliability with outstanding value for applications up to 12 Bar and flow rates up to 530 L/h.
- A range of dosing pumps that are compact, lightweight, robust and simple designed for low discharge pressures, durability and cost effectiveness, mainly used in water treatment and in the food industry in clean-in-place applications. Designed to provide reduced overall operating costs over time, the mechanically-actuated PTFE diaphragm increases diaphragm life by eliminating the stresses inherent in most pump designs.
- TMP1 models are multipurpose pumps and can handle all known reagents. They are recommended for continuous service and can run dry without any damage to the pump.
- TMP1 pumps incorporate a variable eccentric system minimizing pulsation and shock.
- TMP1 dosing pumps consists of durable, metallic housing designed to withstand tough environments and suitable for a large number of industrial uses other than water treatment, such as the injection of reagents at medium pressure.
- TMP1 pumps have an adjustment of flow rate while running or stopped from 0 to 100%, with a maximum temperature of pumped liquid up to 40 °C aimed at delivering exceptional performance across a wide range of flow and pressure environments.

Water Treatment

Performance data



Model	Diameter (mm)	Stroke Length	Stroke Rate	Flow Rate [l/h]	Max. pressure (bar)	Connections		Motor	Gross Weight (kg)	Cardboard box L W H (mm)
						SS316L	PVDF			
TMP1A065C**A40000	65	2	116	9	12	BSPf 1/4"	8x12 PE hose	0,25/4	16	450 x 300 x550
TMP1C096B**A40000	96	4	78	53	10	BSPf 3/8"	DN 10			
TMP1D124B**B40000	124	6,4	78	170	7	BSPf 3/4"	DN 20	0,37/4	20	
TMP1D124B**B20000			340	5	0,37/2					
TMP1E140B**B20000	140	7.4	156	530		BSPf 1"	DN 25	0,37/2		

1) (**) Available wetted parts: SS316L and PVDF ;

2) In addition to the STD motor, it is also can be equipped with VSD motor (Variable Speed Drive) or Flame-Proof motor (Exd IIB T4);

3) Tested with water @ 20°C @ 50 Hz; Flow rate values with motor at 50Hz. Multiply by 1.2 for 60 Hz.

Liquid End Material

Material	Liquid End Body			
	21	41	24	44
Pump Head	SS 316L	PVDF	SS 316L	PVDF
Diaphragm	PTFE		PTFE	
Seal	FPM		EPDM	
Ball	SS 316L	Ceramic	SS 316L	Ceramic
Ball Seat		PTFE		PTFE

Water Treatment



Performance curve P [barg] – Q [L/h]

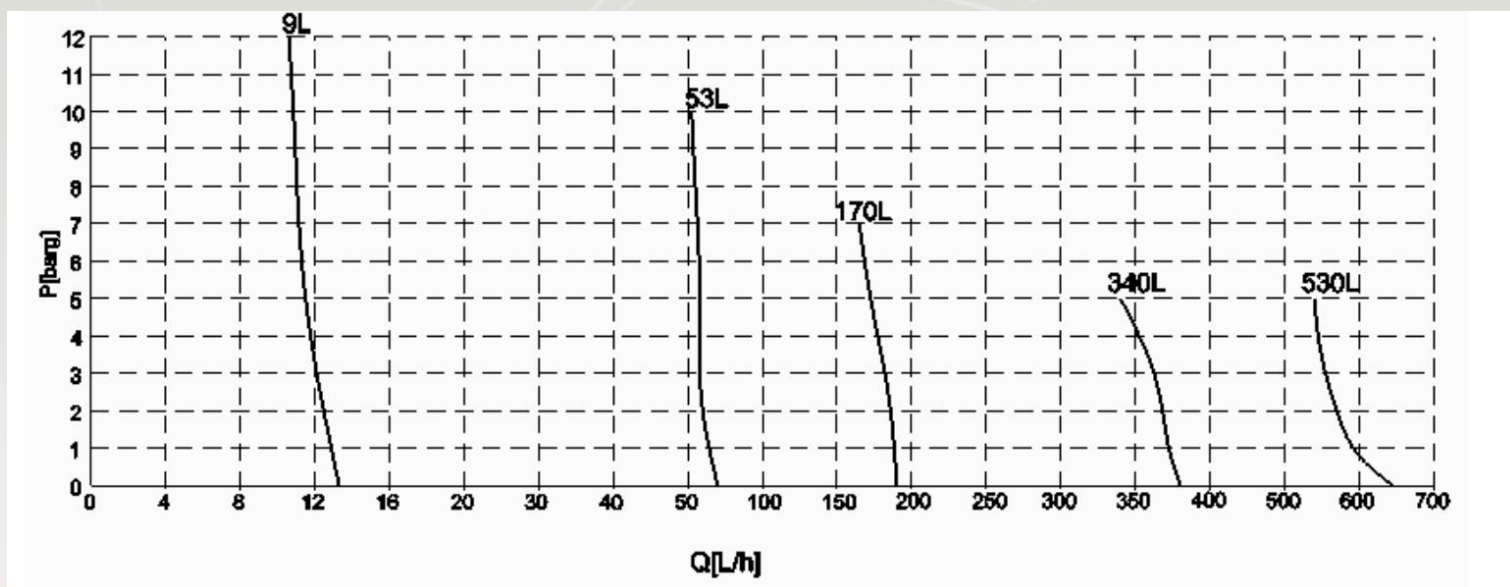

Water Treatment



Installation Drawing

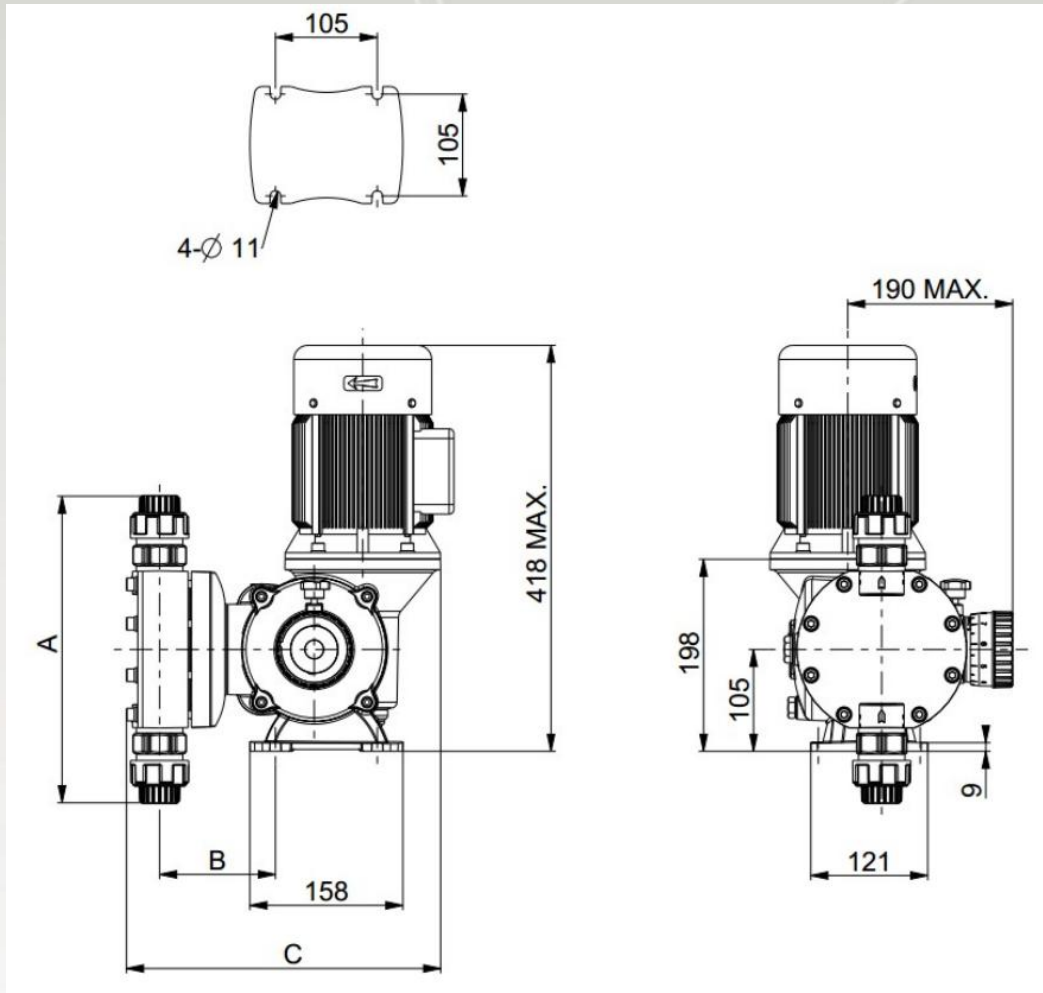

TMP1 Pump Head Material	Diaphragm dia. 65 mm			Diaphragm dia. 96mm			Diaphragm dia. 124mm			Diaphragm dia. 140mm						
	Connection	A	B	C	Connection	A	B	C	Connection	A	B	C	Connection	A	B	C
PVDF	8x12 hose	166	104	303	BSPf 3/8"	222	108	301	BSPf 3/4"	293	118	322	BSPf 1"	316	119	323
SS316L	BSPf 1/4"	175	108	294	BSPf 3/8"	167	107	293	BSPf 3/4"	216	113	306	BSPf 1"	251	120	319